



Eugene Simpson Stadium Park Renovation

Park and Recreation Commission Update

March 16, 2023

Project Location

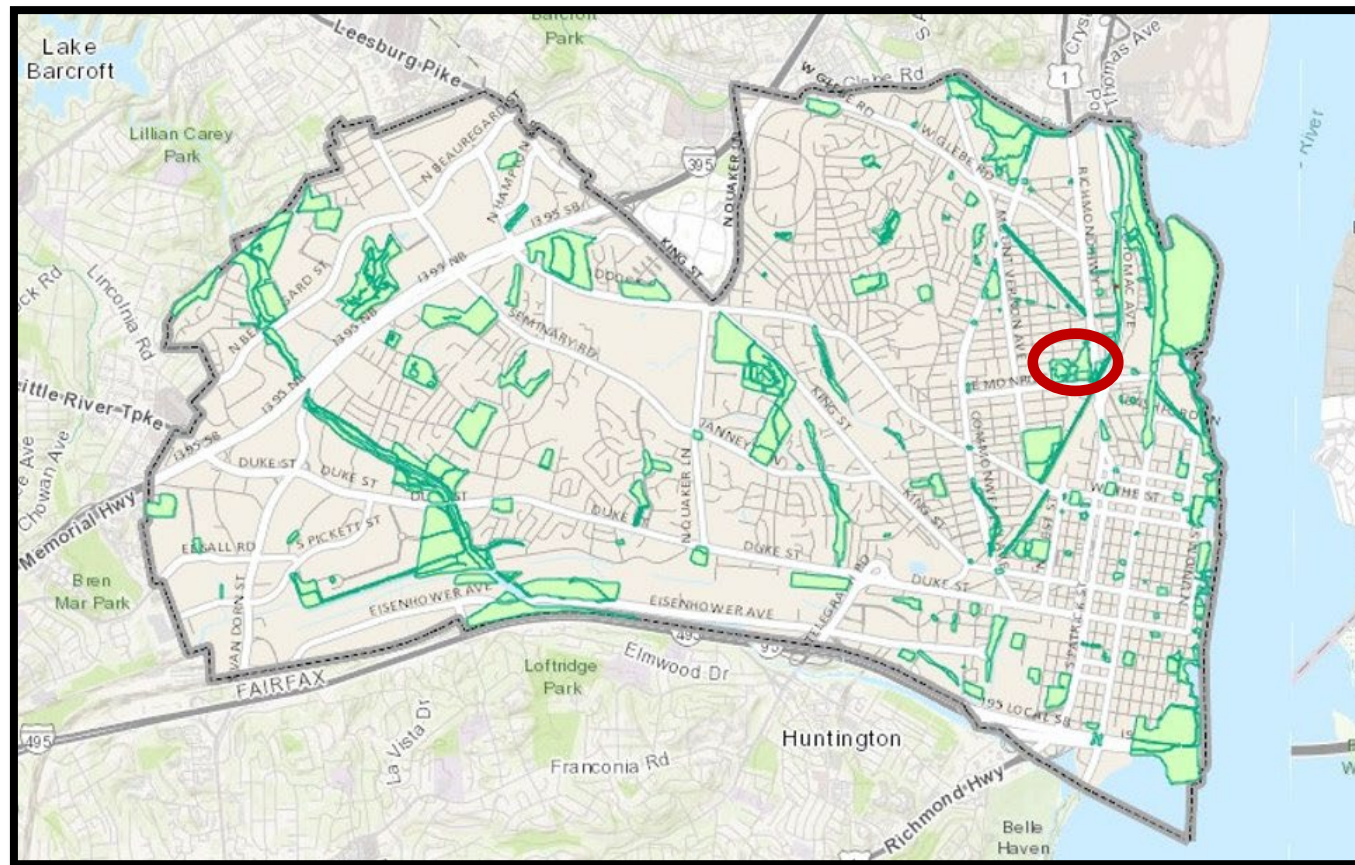

Agenda



Commission Action Requested:

- Provide feedback and input
- Docket the project for public hearing on May 20th, 2023



Eugene Simpson Park Ball Field Renovations

Design: 2021 to 2024 ➔ Construction: 2024 to 2026

Tell the City, plan your Park!

Synthetic
Turf Field

Natural
Turf Field

Synthetic
Turf Mound

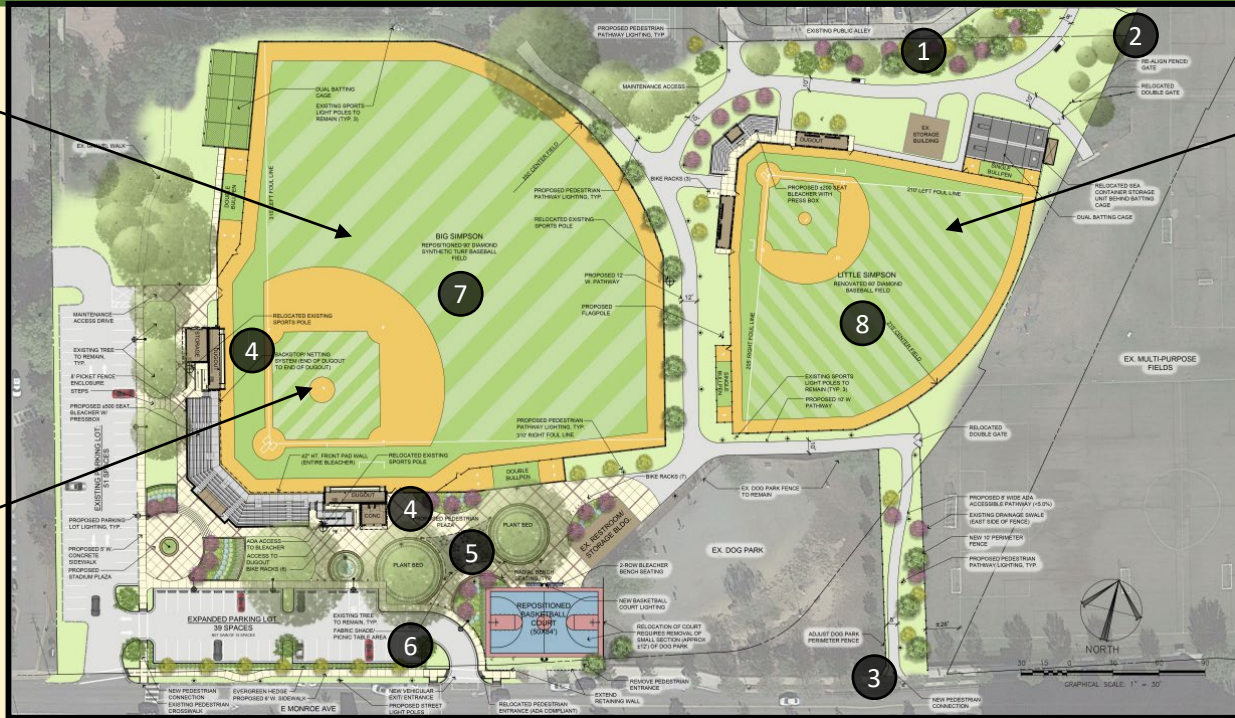

*Project
Goals:*

#1 Plant Trees
along the northern
alleyway

#2 Provide
hardscape
trails in the
east half of the
park

#3 Provide
new ADA
access from
Monroe Ave.

#4 Install new
bleachers,
equipment
storage and
Concessions

#5 Create a
picnic area
near the
concessions

#6 Expand the
parking lot and
improve
circulations

#7 Improve
the turf at Big
Simpson with
option for
synthetic turf

#8 Improve
natural turf
drainage at
Little Simpson



Eugene Simpson Park Ball Field Renovations

Design: 2021 to 2024 ➡ Construction: 2024 to 2026

Tell the City, plan your Park!



Project Goals:

#1 Plant Trees along the northern alleyway

#2 Provide hardscape trails in the east half of the park

#3 Provide new ADA access from Monroe Ave.

#4 Install new bleachers, equipment storage and Concessions

#5 Create a picnic area near the concessions

#6 Expand the parking lot and improve circulations

#7 Improve the turf at Big Simpson with option for synthetic turf

#8 Improve natural turf drainage at Little Simpson

Project Schedule

2022

- June - Community Engagement on Concept Plan
- Summer - Design Development
- Fall - Community Engagement on Revised Design

2023

- March & May 2023 – P&R Commission Meeting and Public Hearing
- June - Development Special Use Permit Public Hearings
- Summer/Fall - Final Design

2024-2026

- Early 2024 - Construction Procurement
- Late 2024 to early 2026 - Construction

Community Engagement Process

Completed Outreach

- 2014 Citywide Park Plan/2021 Amendment
- Direct Outreach to Stakeholder Groups
 - *ACPS* – Scoreboard, Snack bar, level of play standards, field design, storage
 - *ALL* - Snack bar, Level of play standards, storage, field design
 - *Reds* - Field design
 - *Park Donor* - Scoreboard, Field design
- June 2022 - Youth Sports Advisory Board (6/13)
- June 2022 - Park and Recreation Commission (6/16)
- January 2023 - Master Gardeners of Alexandria

Forecasted Outreach

- March & April 2023 - Graffiti Boards
- March & April 2023 - Online Survey
- March 2023 - E-New publications
- March 2023 - Flyers
- April 2023 - Onsite Public Meeting
- April 2023 - Youth Sports Advisory Board

Simpson Park Stakeholder Groups

Adjacent
Neighborhood

Kettle Park
Community
Partners

Sports User
Groups

Alexandria
City High
School

Simpson Park Dog
Owners Group

Commission Feedback

Next Steps

Commission Action Requested:

- Provide feedback and input
- Docket the project for Public Hearing on May 20th 2023

The Project Team will return in May of 2023 to respond to feedback and input received from the Park and Recreation Commission

Additional information:

Mitch Dillon, Project Manager, DPI

Mitch.Dillon@alexandriava.gov

Bethany Znidersic, Division Chief, RPCA

Bethany.Znidersic@alexandriava.gov



Pathway/ Plaza Lights



Parking Lot Lights



Shade Structure



Bleachers

(Big Simpson)



Bleachers

(Little Simpson)



Bleacher Screening



Bio Retention



Site Improvements (View North)



Site Improvements (View South-West)



Site Improvements (View North-West)



Entry Plaza



Entry Plaza



Big Simpson Bleacher



Rear Bleacher Screening



Seating / Rear Bleacher Screening



Basketball Court / Pedestrian Plaza / Seating / Shade Structure



C4 CONCESSIONS VISUALIZATION
A-2019 12" = 1'-0"



C1 CONCESSIONS VISUALIZATION
A-2019 12" = 1'-0"



B4 DUGOUT VISUALIZATION
A-2019 12" = 1'-0"



B1 CONCESSIONS VISUALIZATION
A-2019 12" = 1'-0"



A4 CONTEXT IMAGE
A-2019 12" = 1'-0"



A1 CONTEXT IMAGE
A-2019 12" = 1'-0"

SIMPSON PARK: EXISTING CONDITIONS

HARD TRAILS

BIKE ROUTE

PARK BOUNDS

ATHLETIC
FIELDS



KEYED LEGEND

1. WIDEN PATH 6-8 FEET TO ENABLE NORTH-SOUTH STANDARD PATHWAY
2. ADJUST PLAYGROUND BORDERS, IMPROVE ENTRANCES, AND ADD NATURAL PLAY
3. ADD STROLLER PARKING AND PLAZA AT PLAYGROUND ENTRANCE
4. CREATE OPEN-USE AREA AND IMPROVE PLANTINGS IN PASSIVE USE AREAS
5. CONNECT PATHWAY TO E. DUNCAN AVE
6. USE BOLLARDS TO LIMIT PATHWAY DRIVING ACCESS TO MAINTENANCE VEHICLES
7. PLANT PERIMETER TREES TO CREATE "GREEN ALLEY"
8. PROVIDE NEW HARD TRAILS IN EAST HALF OF PARK
9. PROVIDE NEW FIELD ENTRANCE AND RAMP
10. IMPROVE MAINTENANCE ROUTE TO SOCCER FIELDS
11. PROVIDE NEW BLEACHERS WITH EQUIPMENT STORAGE UNDERNEATH
12. PROVIDE NEW BLEACHERS WITH CONCESSIONS BOOTHS UNDERNEATH
13. CREATE PICNIC AREA NEAR CONCESSIONS
14. EXPAND PARKING LOT
15. ENCOURAGE USE OF FORTY FIVE TOTAL ON-STREET PARKING SPACES ALONG E MONROE AVE AND MAIN LINE BLVD FOR SOCCER FIELD USE
16. IMPROVE DOG PARK TO INCLUDE LIGHTING, TERRACED HILL, TREES, AND PLAY FEATURES
17. ADD MAINTENANCE STORAGE SHELTER AND YARD BETWEEN FIELDS
18. ADD VEGETATED BIOSWALE ALONG DOG PARK EDGE AND AT MAINTENANCE YARD

GRAPHIC KEY

HARD TRAILS

BIKE ROUTE

PARK BOUNDS

OPEN USE AREAS

ENTRANCE PLAZAS

ATHLETIC FIELDS

DOG PARK



2014 Citywide Parks Improvements Plan